



● 工作加工范围

研磨外徑.....1-10mm  
伸出長度.....0.5-10mm  
工作長度.....10-60mm  
重量.....2.32kg

● Working-precce processing scope

Grinding external diametwr..... $\varnothing$ 1-10mm  
Extension external diameter.....0.5-10mm  
Working-piece length.....10-60mm  
Weight.....2.32kg

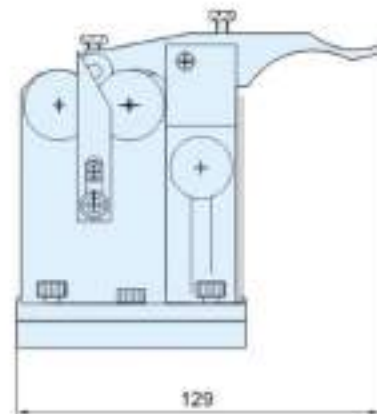
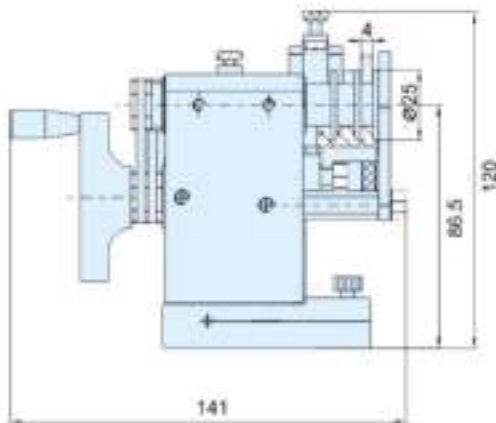

- 小型沖子研磨機可從事小到0.5x10L極小沖的研磨
- 操作簡單, 可得到極高的精密度, 最極小沖頭的研磨利器
- 此款小型沖子研磨機可當檢驗器用, 檢驗20mm以下真圓度
- This grinder can be grinded to min 0.5mm x 10L punch.
- Easy operation, high accuracy best choice for small punches.
- This small-siged punch grinder can also be used for examination purpose, testing the roundness of circles with 20mm or less for diameter.

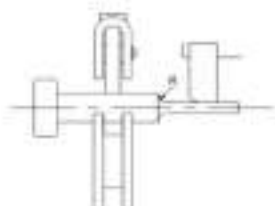

● 工作加工范围

研磨外径..... $\varnothing 3-25\text{mm}$

伸出长度..... $0.5-25\text{mm}$

工作长度..... $20-120\text{mm}$

重量..... $5.8\text{kg}$

● Working-precise processing scope

Grinding external diametwr..... $\varnothing 3-25\text{mm}$

Extension external diameter..... $0.5-25\text{mm}$

Working-piece length..... $20-120\text{mm}$

Weight..... $5.8\text{kg}$

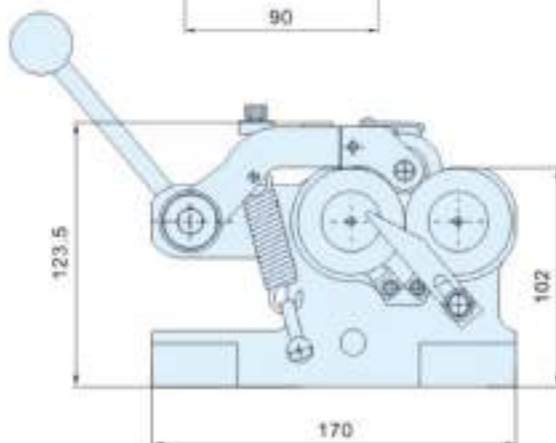
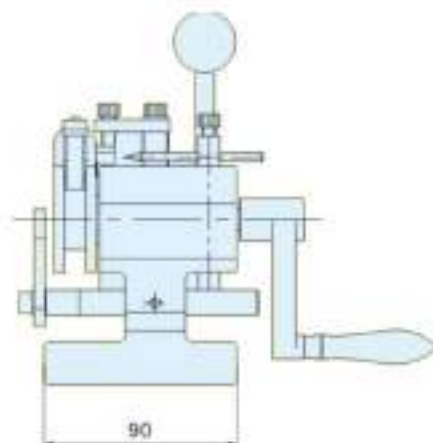

FOR EXAMPLE

1. Conical grinding

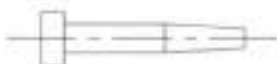

2. Mult-division grinding



3. Cylindrical grinding



4. Radius grinding



- 冲子研磨机安装在平面研磨上，做为圆形冲头的工具
- 使用压壁上的按 滚轮，可稳定操作，研磨精度度可达 $\pm 0.005\text{mm}$ 内
- 研磨加工范围 $\varnothing 3-\varnothing 6\text{mm}$ ，运转中可自动变得同心圆，无需任何调整
- Installed in yhe surface grinding machine, this punch grinder is used as a tool to grind round shaped punch heads
- Using the punch roller for stable operations. High precision grinding of working pieces reaches  $0.005\text{mm}$  and below.
- Grinding scope: $\varnothing 3-\varnothing 6\text{mm}$ , Concentric circles are available during operations no adjustments are needed.



Material:SK2  
Hardness: HRC54°~58°  
Parallelism:  $\pm 0.01\text{mm}$   
Squareness:  $\pm 0.01\text{mm}$

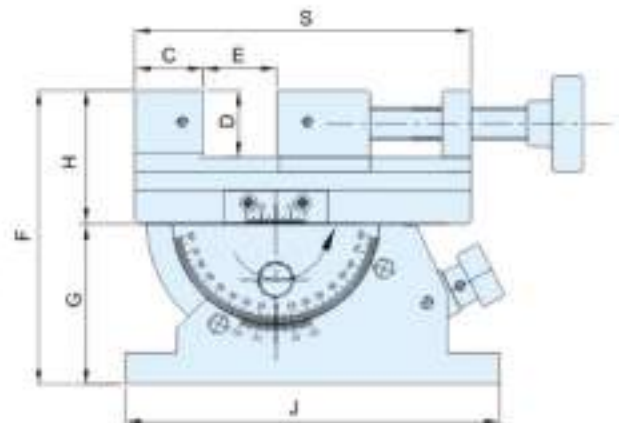
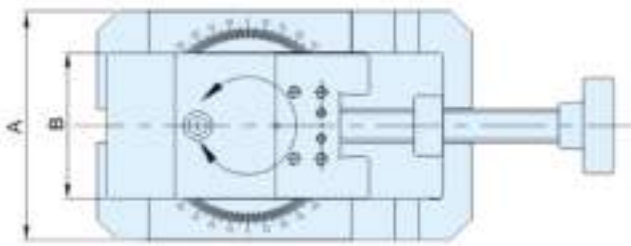

- 刻度精确，适合精密加工
- 水平回转360°
- 水平倾斜45°
- 最适合精密平磨，搪铣床，放电加工机等之平面或倾斜面及角度斜孔加工
- Precision graduation for accurate reading.
- Horizontal swivel through 360°
- The unit tilts45° vertically
- Its swivelling and tilting features make this unit well suited for straight or inclined surface, angular machining on various machine tools as precision grinding machine, boring and milling machine, electrical discharge machine etc.

unit:mm

MODEL NO	A	B	C	D	E	F	G	H	S	J	N.W
PNH-HD80	110	70	33	32	80	141	77	64	162	180	12.9kg



Material:SKS93  
Hardness: HRC56°~60°  
Parallelism: ±0.01mm  
Squareness: ±0.01mm

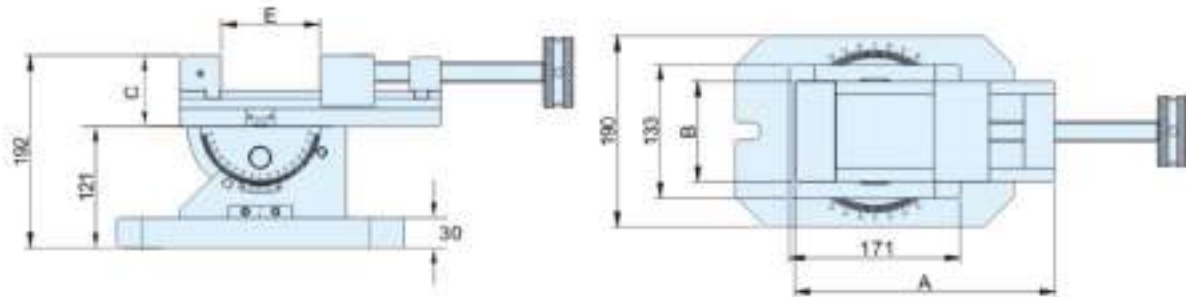

- 主体不分以高碳钢经热处理硬化精密研磨而成，精密度在0.01mm以内。万力主体可做360度回转，倾斜角度为0-45度，並且可以自由调整，万力回转到一定范围内，倾斜角度可达到80度。
- 适用于铣床，磨床，放电加工等机械进行各种角度的加工。为矿大工作物的工范围，在高度方面采用了低式设计；宽度方面采用了小化设计，同时也设定在铣床上面替代铣床万力当多功能虎钳使用。
- This high carbon steel body is precisely grinded after the heat treatment and hardening with the precision below 0.01mm. The universal 3-way angle vise features a 360 rotation and slant angle of 0-45, which can reach up to 80° under appropriate adjustments.
- This angle vise is suitable for any angle of processing in milling, grinding, and electric discharge machines, its altitude adopts the low type design and minimizes the width in order to offer more processing scopes of working pieces, Meanwhile, the device as a multi-function vise in the milling machine

unit:mm

MODEL NO	A	B	C	E	N.W
PNH-HDV150	260	100	71	155	21.7KG



● 主要参数

基准精度.....	Ø3-25mm
筒夹直径.....	0.5-25mm
中心高度.....	20-120mm
筒夹偏心上下调整量.....	5.8kg
分度盘齿数, 精度.....	24,15°±5'
重量.....	7.75kg

● Major parameters

Datum parameters.....	Ø3-25mm
Punch diameter.....	0.5-25mm
Center height.....	20-120mm
Punch center adjustment.....	5.8kg
Rotary Table Gear No./precision...	24,15°±5'
Weight.....	7.75kg

上下调(偏心±10mm)

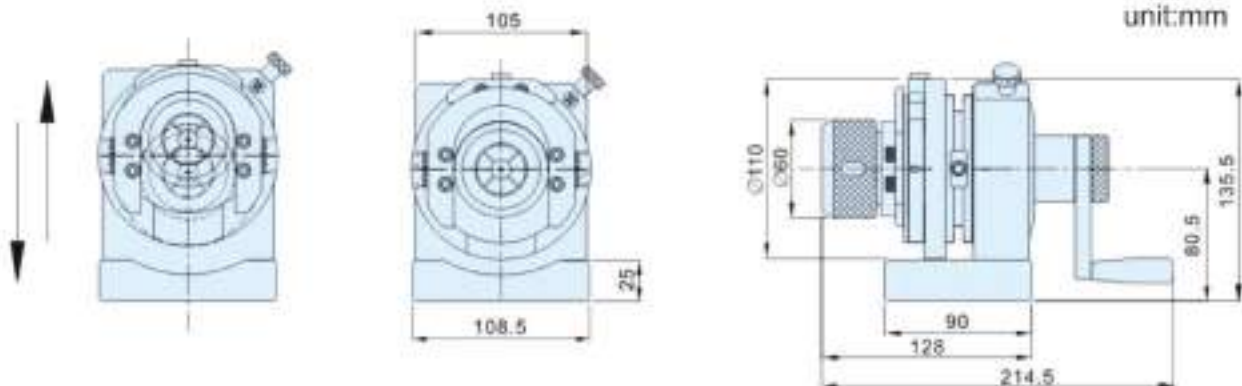

- 筒冲子成型器适用于平面磨床, 放电机电及万能工具磨床, 对于各种形状的冲头可进行精密, 快速研磨加工, 对于圆径不同规格的工作可不必调整中心高度即可使用。
- 该产品设计了能上偏心调动功能, 可快捷做上下偏心加工, 有中心穿孔, 便于超长工件加工, 在一定范围内可以进行定位加工。
- Collet punching former is used in surface grinding machine, discharging machine and universal tool and cutter grinder, it grinds and machines all shapes of punches accurately and rapidly, it is no need to adjust height to process different diameter work pieces.
- This product is designed to be adjusted easily up and down eccentrically, it also can drill central hole and work on super long piece, and in some situations it can carry out positioning machining.



主要参数

基准精度.....	0.01mm
筒夹直径.....	Ø3~25mm
中心高.....	88~89mm
筒夹偏心上下调整量.....	±10mm
筒夹横向移动量.....	±12.5mm
分度盘齿数, 精度.....	24, 15°±5'
净重.....	8.9kg

Major parameters

Datum precision.....	0.01mm
Punch diameter.....	Ø03~25mm
Center height.....	88~89mm
Punch center adjustment.....	±10mm
Transversal travel of slider.....	±12.5mm
Rotary Table Gear No./precision.....	24, 15°±5'
Weight.....	8.9kg

上下调(偏心±10mm)

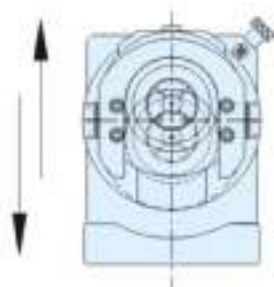

横向移动  
(左右±12.5mm)

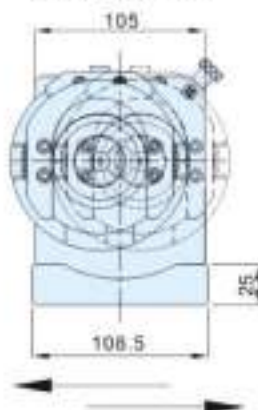

unit:mm

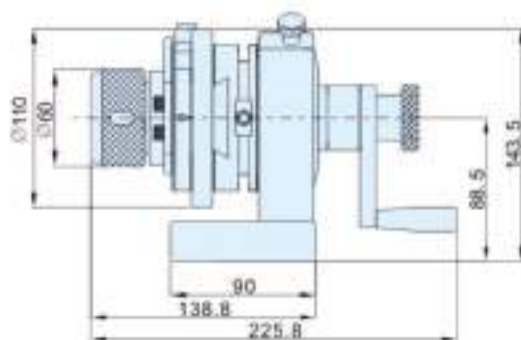

- 筒夹双向冲子成型器适用于平面磨床, 放电加工及万能工具磨床, 对于各种形状的冲头可进行精密, 快速研磨加工, 对于圆径不同规格的工件可不必调整中心高度即可使用。特别适合于数量较多且规格不一的工作。
- 该产品设计了能上偏心调整和横向移动双向功能, 可快捷做上下偏心加工和横向左右移动加工, 从而能提高加工效率。
- Collet double-direction punching former is used in surface grinding machine, discharging machine and universal tool and cutter grinder, it grinds and machines all shapes of punches accurately and rapidly, it is no need to adjust height to process different diameter work pieces.
- It is suitable for different specification pieces and mass productions. This product is designed to be adjusted up and down and eccentrically, and be adjusted horizontally in double direction. It can be adjusted rapidly and works efficiently.



主要参数

V形槽夹持直径.....	Ø4~50mm
修整砂轮最大直径.....	Ø200mm
V形槽夹持长度.....	22mm
中心高.....	95~96mm
修整砂轮圆弧最大直径	
凸弧.....	R55mm
凹弧.....	R110mm
V形块调整量	
分度盘齿数, 精度.....	24, 15°±5°
净重.....	9.3kg

Major Parameters

V-Groove Holding Diameter .....	Ø3-25mm
Dressing Wheel Maximum Diameter.....	0.5-25mm
V-Groove Holding Length.....	20-120mm
Center Height.....	5.8kg
Dressing Wheel Arc Maximum Diameter	
Flange Arc.....	R55mm
Indent Arc.....	R110mm
V-Shape Block Adjustment.....	33mm
Rotary Table Gear No./Precision.....	24, 15°±5°
Weight.....	9.3kg

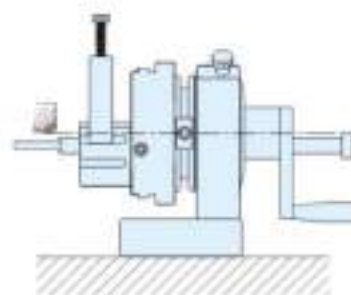
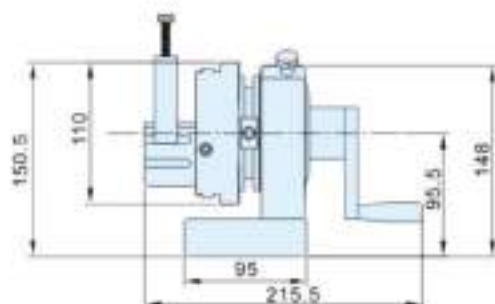

- 大型单向冲子成型器适合于平面磨床放电加工机及万能工具磨床，对于各种形状的冲头可进行精密研磨。本产品具备中心贯穿孔，可供工件延伸加工。
- 附有弓柄臂，用于修整内外圆弧。
- Large-scale standard single punching former is suitable for flat-surfaced grinders and universal grinder and cutters. Depending on the types of shapes required, punching head can be created with great precision by the punch formers. This product has the function of perforation through the mid-point and different functions and abilities may be added to extent it performances.
- It comes with an arc-bow handle that assist the adjustment and maintenance of the internal and external circular grinder.



三爪冲子成型器 PNH-PCJ

3-Jaws Punch Former PNH-PCJ

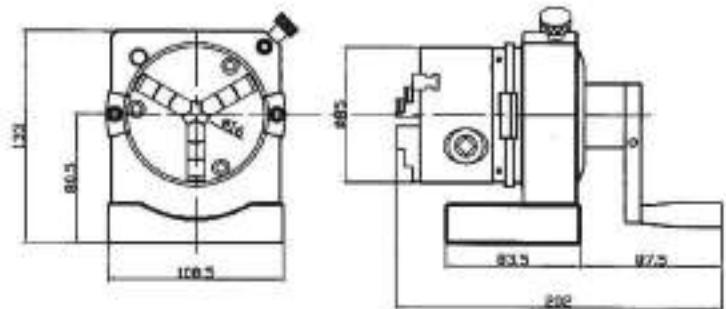

PNH-PCJ 冲子成型器为方便使用，特别加上三爪夹头，可以快速的将工件夹头特使用。应三爪夹头的累计公差爪夹特不同大小工作时会有差异，所以设计有水平及真圆的调整功能供使用者自行调整，所以本产品适合用于大批量的使用。附有爪配件可供较大外径工件的夹持。

PNH-PCJ punch forming machine for the convenience of use, particularly with three jaw chuck, can be used to fast the workpiece clamping. Due to the accumulating of three jaw chuck tolerance workpiece clamping different size will have differences, so the design level and true round adjustment function for the user to adjust, so this product is suitable for mass production.

Attached the claw parts available for large diameter workpiece clamping.

三爪孔径：16毫米

最小夹持直径： 外径@2mm， 内径@24mm

最大夹持直径： 外径@70mm， 内径@64mm

Three jaw size: 16mm

Minimum clamping diameter: Outside diameter @2mm, Inside diameter @24mm

Maximum clamping diameter: Outside diameter @70mm, Inside diameter @64mm



主要参数

V型槽夹持直径.....	Ø4-50mm
修整砂轮最大直径.....	Ø200mm
V型夹持长度.....	22mm
中心高.....	95~96kg
修整砂轮圆弧最大直径	
凸弧.....	R55mm
凹弧.....	R110mm
滑动处横向移动量.....	±17mm
V型块调整量.....	33mm
分度盘齿数, 精度.....	24, 15°±5"
重量.....	11.4kg

Major parameters

V-groove Holding Diameter.....	Ø4-50mm
Dressing Wheel Maximum Diameter.....	Ø200mm
V-groove Holding Length.....	22mm
Center Height.....	95~96kg
Dressing Wheel Arc Maximum Diameter	
Flange Arc.....	R55mm
Indent Arc.....	R110mm
Sliding Horizontal Movement.....	±17mm
V-shape Block Adjustment.....	33mm
Rotary Table Gear No./Precision.....	24, 15°±5"
Weight.....	11.4kg

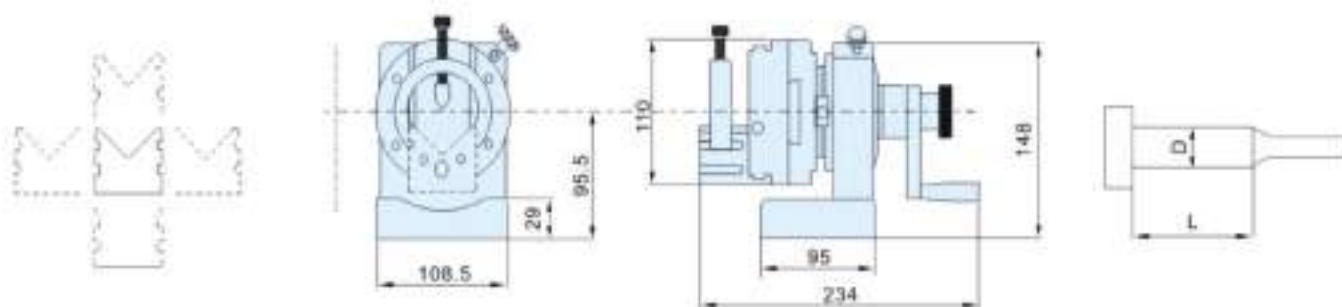
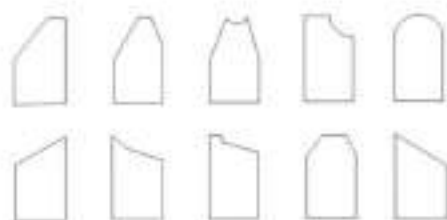

- 大型双向冲子成型器适用于平面磨床及万能工具磨床，对于各种形状的冲头进行精密研磨，并可用于EDM放电加工
- 可用于修整直线和外圆弧（内R和外R）的各截形砂轮。
- This large-size, two-way punch former is suitable for the use in both surface grinder and universal tool grinders. It is ideal for the precision grinding for various punch and electric discharge machine (EDM) processing.
- Dressing straight lines and internal/external R sanding wheels are available

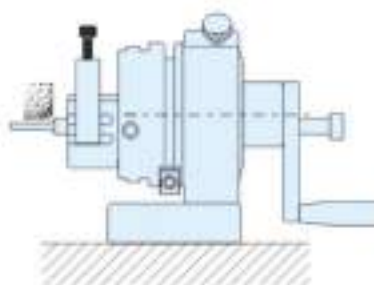
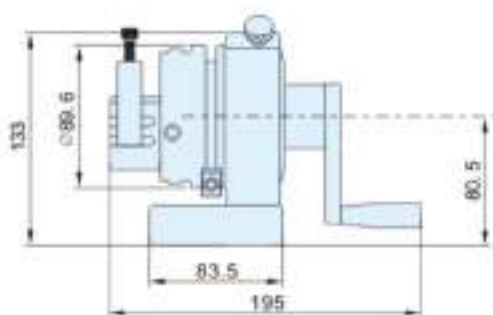

主要参数

V型槽夹持直径.....	Ø4-30mm
修整砂轮最大直径.....	Ø200mm
V型夹持长度.....	22mm
中心高.....	80~81kg
修整砂轮圆弧最大直径	
凸弧.....	R45mm
凹弧.....	R100mm
V型块调整量.....	25mm
分度盘齿数, 精度.....	24, 15°±5'
重量.....	7kg

Major parameters

V-groove Holding Diameter.....	Ø4-50mm
Dressing Wheel Maximum Diameter.....	Ø200mm
V-groove Holding Length.....	22mm
Center Height.....	95~96kg
Dressing Wheel Arc Maximum Diameter	
Flange Arc.....	R55mm
Indent Arc.....	R110mm
Sliding Horizontal Movement.....	±17mm
V-shape Block Adjustment.....	33mm
Rotary Table Gear No./Precision.....	24, 15°±5'
Weight.....	11.4kg

- 單向向冲子成型器适用于平面磨床放电加工机及万能工具磨床，對於各种形状的冲头可进行精密研磨，本产品具备中心贯穿孔，可供工件延伸加工。
- 附有弓柄器，用於修整内外圆弧。
- Single punching former is suitable for flat-surfaced grinder and universal grinder and cutters. Depending on the types of shapes required, punching head can be created with great precision by the punch formers. This product has the function of perforation through the mid-point and different
- function and abilities may be added to extent it performances.  
It comes with an arc-bow handle that assist the adjustment and maintenance of the internal and external circular grinder,



#### 主要参数

V型槽夹持直径.....	Ø4-30mm
修整砂轮最大直径.....	Ø200mm
V型夹持长度.....	22mm
中心高.....	80~81kg
修整砂轮圆弧最大直径	
凸弧.....	R45mm
凹弧.....	R100mm
滑动处横向移动量.....	±12.5mm
V型块调整量.....	25mm
分度盘齿数, 精度.....	24, 15°±5'
重量.....	8.5kg

#### Major parameters

V-groove Holding Diameter.....	Ø4-30mm
Dressing Wheel Maximum Diameter.....	Ø200mm
V-groove Holding Length.....	22mm
Center Height.....	80~81kg
Dressing Wheel Arc Maximum Diameter	
Flange Arc.....	R45mm
Indent Arc.....	R100mm
Sliding Horizontal Movement.....	±12.5mm
V-shape Block Adjustment.....	25mm
Rotary Table Gear No./Precision.....	24, 15°±5'
Weight.....	8.5kg

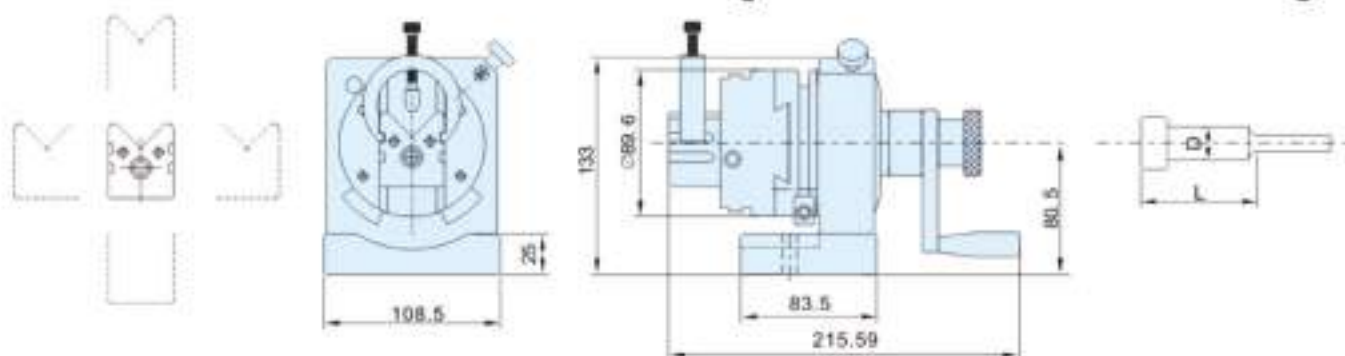
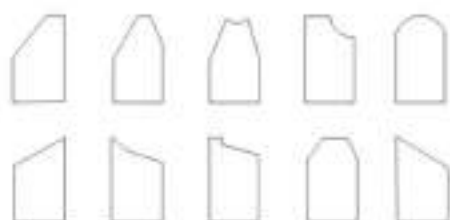

- 双向冲子成型器适用于平面磨床及万能工具磨床，可对各种形状的冲头可进行精密研磨，并可用于 E.D.M. 放电工机电极的精密加工，本产品具备横向移动双向功能。
- 附有弓柄臂，具有修整砂轮的功能，可用于修整直线的圆弧组成的截形砂轮。
- This two-way punch former is suitable for the use in both surface grinders and universal tool grinders. It is ideal for the precision grinding of various punch and electric discharge machine (EDM) processing. This product has the function of lateral and bidirectional movements.
- The attached stick-arm features the dressing wheel function. Dressing straight line and various sanding wheels are available.



精密夹具、磨床及铣床配件目录  
Accessories for precision fixtures,  
grinding machine and milling machines



透视砂轮修整器 PNH-PKT50  
VISUAL RADIUS ANGLE DRESSER

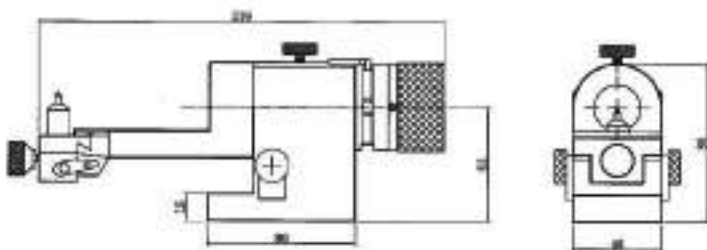

中心高.....62毫米  
最大修整砂轮直径.....200毫米  
最大凸弧半径.....10毫米  
最大凹弧半径.....25.4毫米  
修整角度.....90°-0°-95°  
滑塊角度.....22毫米

Center height.....62mm  
Max wheel diameter.....200mm  
Max convex radius.....10mm  
Max concave radius.....25.4mm  
Dressing angle.....90°-0°-95°  
Tangential travel.....22mm

PNH-PKT50透视砂轮修整器主要用于平面磨床和万能工具磨床，修整由直线和圆弧组  
易地修整截形砂轮。通过透视镜可观察到金刚笔尖和砂轮待修表面的接触情况，可以容易  
地修整圆弧，直线，并达到理想的精准。

Model PNH-PKT50 Visual Universal Wheel Dresser Adaptable on Surface grinder and  
universal tool grinder for dressing grinding wheel into various cross sections of flat or  
curved shapes.

By "SIGHTING" the diamond point through the lens, radius and angles can easily be  
made perfectly tangent-Visually-Even with diamond Likewise radius can be blended  
together with most unbelievable accuracy.

Material:SK2  
Hardness: HRC54°~58°



PNH-JA50A

- PNH-JA50A  
砂轮角度由0~60°随意修整，最大行程50mm，并可做为角度检查，两垫轮的中心距离±0.002mm内
- Dressing angles range from 0~60°, with the maximum travel reaching 50mm. Angle inspection is available. Center distance between wheels: ±0.002mm

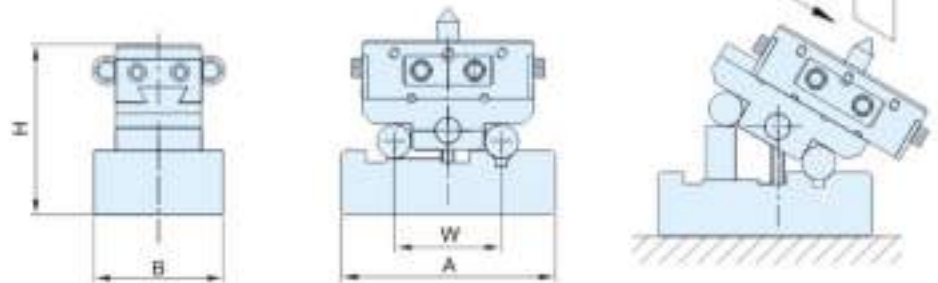

PNH-JA50B

- PNH-JA50B/C  
採用一体成型的设计理念，從0~45°任意的修整，最大行程50mm，并可做为正弦的角度检查，適合卧立使用。
- Adopting the one-body formed design, the dressing angle between 0~45° is adjustable. The maximum travel reaches 50mm and the sine angle inspection is available. Suitable for vertical and horizontal uses.



PNH-JA50C

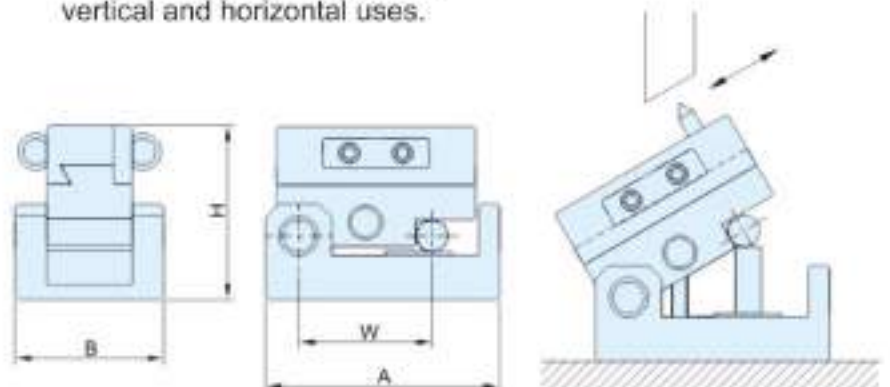

unit:mm

MODEL NO	L	W	H	h	ANGLE	N.W
PNH-JA50A	100	60	79.5	50	0~60°	2.1KG
PNH-JA50B	88	56	67		0~45°	1.51KG
PNH-JA50C	88	56	65.5			0.46KG



精密夹具、磨床及铣床配件目录  
Accessories for precision fixtures,  
grinding machine and milling machines

Material:SK2  
Hardness: HRC54°~58°  
Parallelism:  $\pm 0.005\text{mm}$   
Squareness:  $\pm 0.005\text{mm}$

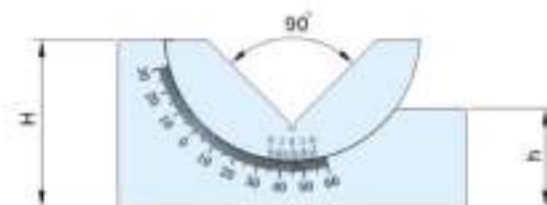
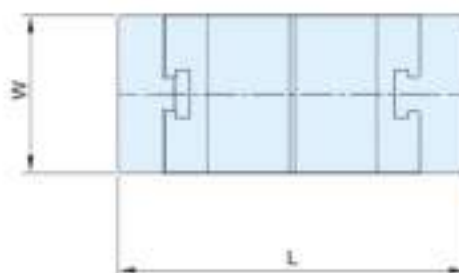
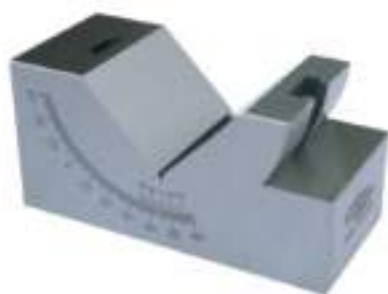

- Ap角度垫规系列，是采用SK2高碳钢经精密研磨而成 $\pm 0.005\text{mm}$ ，角度精度为 $\pm 10''$
- AP angle plate series adopt the Sk2 high carbon steel, with grinding precision reaching  $\pm 0.005\text{mm}$  and the angle precision  $\pm 10''$

unit:mm

MODEL NO	L	W	H	h	N.W
PNH-AP1	102	46	49	29	1.4KG
PNH-AP2	102	30	49	29	0.9KG
PNH-AP3	75	25	35	21.5	0.4KG

Type: 刻字, 铭板



精密夹具、磨床及铣床配件目录  
Accessories for precision fixtures,  
grinding machine and milling machines

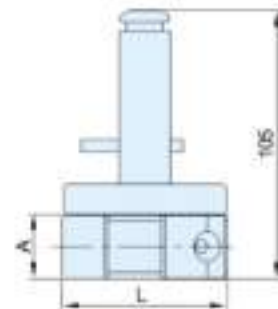
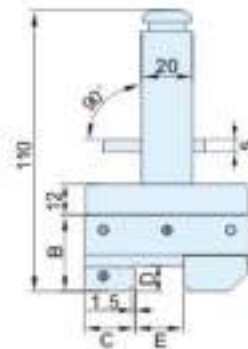

Material: SUS440  
Hardness: HRC50°~56°  
Parallelism:  $\pm 0.003\text{mm}$   
Squareness:  $\pm 0.005\text{mm}$

MODEL NO	L	A	B	C	D	E	N.W
PNH-EH20	65	25	30	20	10	20	0.8KG

unit:mm

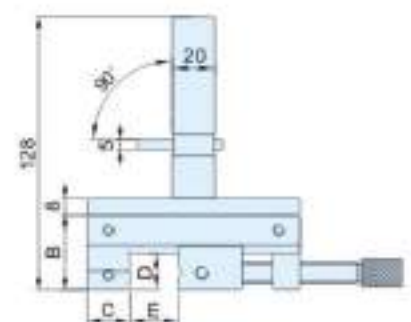
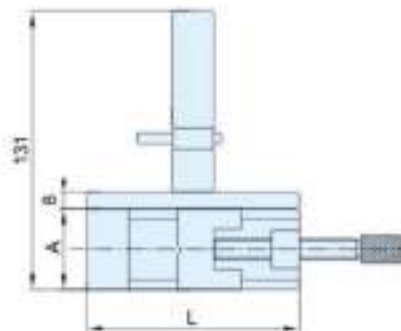

Material: SUS440  
Hardness: HRC50°~56°  
Parallelism:  $\pm 0.003\text{mm}$   
Squareness:  $\pm 0.005\text{mm}$

- Eh系列之迷你型万能，适合用来作为放电电极夹具。
- 万能滑座十字V型槽设计提供各种形状的电极作垂直或水平向进行放电加工处理。
- EH series mini-type vise is suitable for use as electrode fixture.
- The sliding seat cross V-groove offers various electrode plates for either vertical or horizontal electric discharge processing.

MODEL NO	L	A	B	C	D	E	N.W
PNH-EH35	100	38	35	20	17	48	1.12KG

unit:mm



精密夹具、磨床及铣床配件目录  
 Accessories for precision fixtures,  
 grinding machine and milling machines

Material: SUS440  
 Hardness: HRC50°~56°  
 Parallelism: ±0.003mm  
 Squareness: ±0.005mm

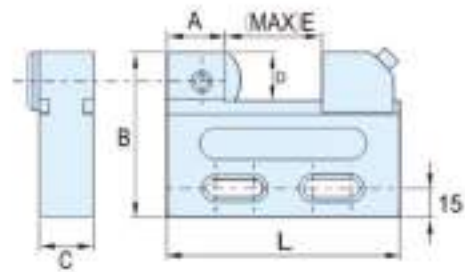

PNH-ST50

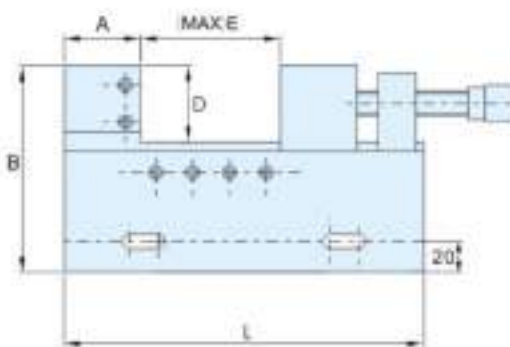

PNH-ST100

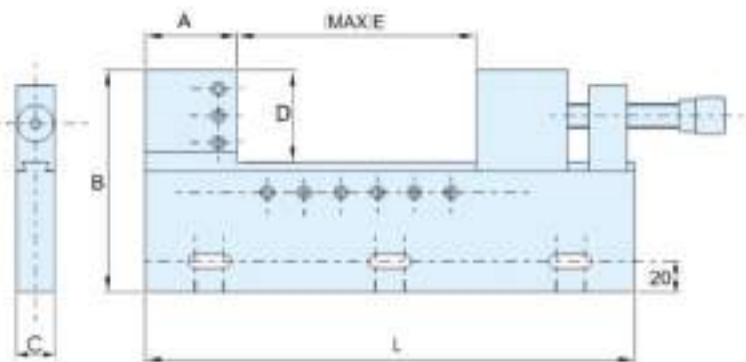

PNH-ST150

unit:mm

MODEL NO	L	A	B	C	D	E	N.W
PNH-ST50	120	25	85	28	25	0-50	1.03KG
PNH-PT100	235	50	135	25	50	0-100	4.81KG
PNH-PT150	320	60	145	25	60	0-150	6.41KG



精密夹具、磨床及铣床配件目录  
Accessories for precision fixtures,  
grinding machine and milling machines

Material: SUS440  
Hardness: HRC50°~56°  
Parallelism: ±0.003mm  
Squareness: ±0.005mm

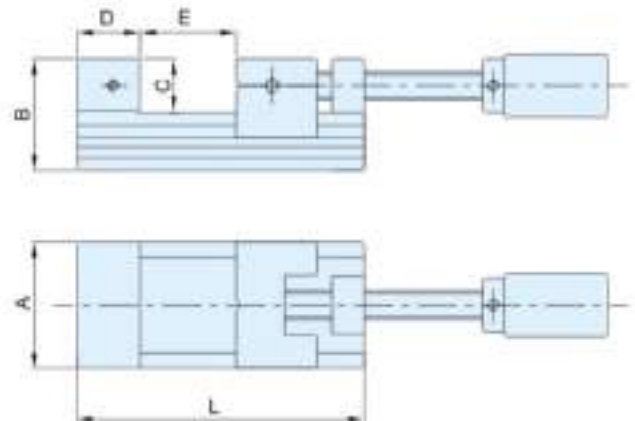

unit:mm

MODEL NO	L	A	B	C	D	E	N.W
PNH-SVE30	180	70	69	30	35	0-100	5.0KG



超精密工具萬力

SUPER PRECISION TOOL MAKERS VISE

Material: SK2  
Hardness: HRC54°~58°  
Parallelism: ±0.003mm  
Squareness: ±0.003mm

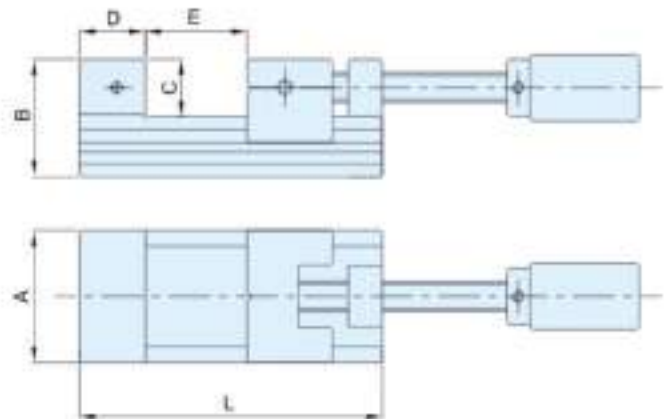

unit:mm

MODEL NO	L	A	B	C	D	E	N.W
PNH-PVC70	160	70	62	30	35	0-80	4.4KG
PNH-PVC90	210	90	80	40	38	0-120	8.7KG



Material:SK2  
Hardness: HRC54°~58°  
Parallelism:  $\pm 0.003\text{mm}/100\text{MM}$   
Squareness:  $\pm 0.005\text{mm}/100\text{MM}$

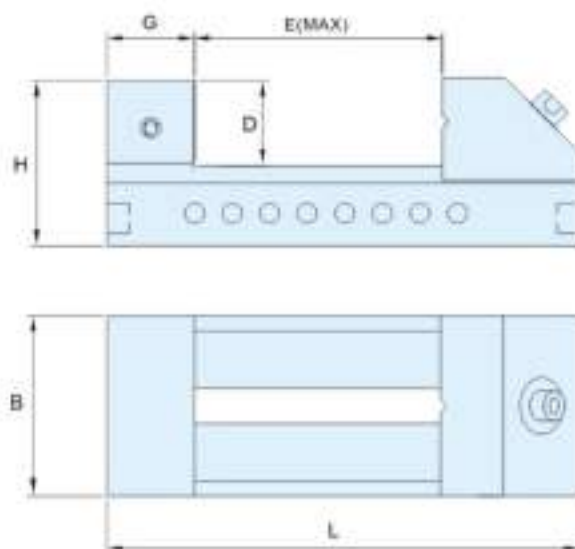

- VA型吊拉万力
- 保持高度稳定的精密度
- 代替角尺来校正或测定工作物
- VB型吊拉万力
- 不但具有VA型特点外，还可用吊拉器来调整滑座之前进后退

#### VA Type Hoist Vise

- Keeping stable precision
- Replacing square master to revise and measure working pieces

#### VB Type Hoist Vise

- With the feature of VA type, this tool maker vise can use the hoist to adjust the forward/backward/backward movements of sliding seat.

unit:mm

MODEL NO	L	A	B	C	D	E	N.W
PNH-VA20	149	47	57	30	74	29	1.8KG
PNH-VA25	169	62	62	30	89	34	2.8KG
PNH-VA30	189	72	66	35	99	34	4.1KG
PNH-VB10	65	25	30	20	20	10	0.27KG
PNH-VB15	225	36	40	30	40	20	0.65KG
PNH-VB20	230	47	57	30	74	29	1.7KG
PNH-VB25	287	62	62	30	89	34	2.8KG
PNH-VB30	330	72	68	35	99	34	4.0KG
PNH-VB35	225	88	85	40	120	45	7.2KG
PNH-VB40	230	98	85	40	125	45	8.8KG
PNH-VB50	287	125	100	50	157	50	14.5KG
PNH-VB60	330	150	100	50	200	50	19.4KG

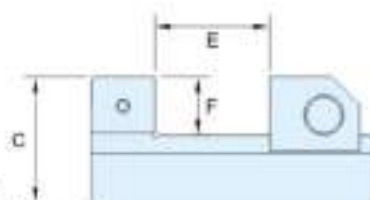

Material:SKD11  
Hardness: HRC58°~62°  
Parallelism:  $\pm 0.003\text{mm}$   
Squareness:  $\pm 0.003\text{mm}$

- 采用特殊钢材经生冷处理及精密研磨而成。
- 表面採用“拋光”研磨，光亮如鏡，不易刮傷，生銹及變形，用於加工鎢鋼刀、製造高精密成型夾具及放電加工。
- Adopting the special steel materials, this tool maker vise is built under the subzero treatment and fine grinding.
- Polishing surface is like mirror and is resistant for scrape, rust, and transformation. Suitable for the Processing of tungsten steel cutting tools, the manufacture of high precision formed fixtures, and electric electrode processing.

unit:mm

MODEL NO	L	A	B	C	D	E	N.W
PNH-HS15N	85	38	40	38	35	20	0.7KG
PNH-HS25N	110	60	50	60	50	23	1.6KG
PNH-HS30N	190	72	67	72	100	35	3.96KG

## 轉牙型拋光工具萬力

### POLISHING TOOL MAKERS VISE

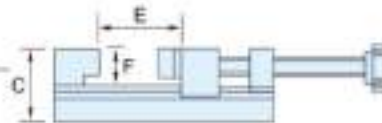
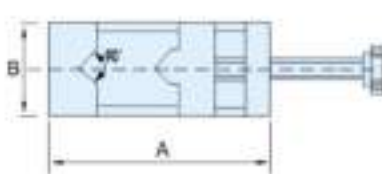

Material:SKD11  
Hardness: HRC58°~62°  
Parallelism:  $\pm 0.003\text{mm}$   
Squareness:  $\pm 0.003\text{mm}$

- 采用特殊钢铁经热处理及精密研磨而成。
- 表面採用“拋光”研磨，光亮如鏡，不易刮傷，生銹及變形，用於加工鎢鋼刀、製造高精密成型夾具及放電加工。
- 研磨圓柱形工件時更為方便精準。
- Adopting the special steel materials, this tool maker vise is built under the subzero treatment and fine grinding.
- Polishing surface is like mirror and is resistant for scrape, rust, and transformation. Suitable for the Processing of tungsten steel cutting tools, the manufacture of high precision formed fixtures, and electric electrode processing. It is ideal for processing of column type working pieces.

unit:mm

MODEL NO	L	A	B	C	E	F	N.W
PNH-HS25D	100	170	60	65	62	35	45KG

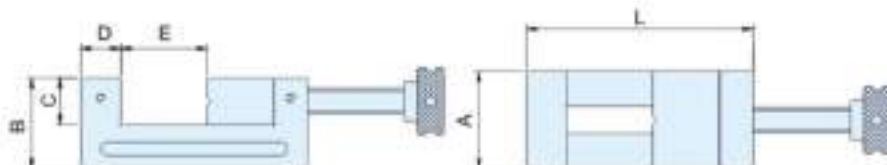

Material:SK2  
Hardness: HRC54°~58°  
Parallelism:  $\pm 0.003\text{mm}$   
Squareness:  $\pm 0.005\text{mm}$

- 适用于小工件的研磨及放电加工
- 代替角尺来校正或测定工作物
- Suitable for small working piece grinding electric electrode processing
- Replacing square master to revise and measure working pieces

unit:mm

MODEL NO	L	A	B	C	D	E	螺杆	N.W
PNH-VD20	154	47	53	24	25	0~55	8/5" - 8T/in	2.1KG
PNH-VD25	175	62	59	29	25	0~75	8/5" - 8T/in	3.3KG
PNH-VD30	180	72	69	29	30	0~70	4/3" - 8T/in	5KG
PNH-VD35	250	88	73	38	35	0~120	1" - 6T/in	8.3KG
PNH-VD40	250	98	73	38	35	0~120	1" - 6T/in	9.5KG

## 轉牙型拋光工具萬力

### POLISHING TOOL MAKERS VISE

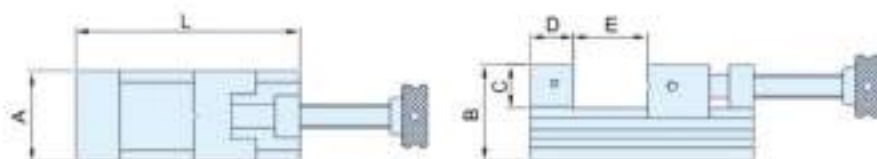

- 滑座的“倒勾”型设计，有效消除滑座在强力作用下产生“上浮”弊端，使加工工件的精度得到更有效的保障。
- The specially-designed reverse hook eliminates effectively the floating of sliding seat under the strength influence, thus ensuring the precision of working pieces.

unit:mm

MODEL NO	L	A	B	C	D	E	螺杆	N.W
PNH-VE20	140	48	55	25	25	0~75	8/5" - 8T/in	1.8KG
PNH-VE25	160	63	69	30	30	0~85	8/5" - 8T/in	2.8KG
PNH-VE30	180	73	78	35	35	0~95	4/3" - 8T/in	4.1KG
PNH-VE40	230	98	92	45	40	0~120	1" - 6T/in	0.27KG



Material:SK2  
Hardness: HRC54°~58°  
Parallelism: ±0.003mm  
Squareness: ±0.005mm

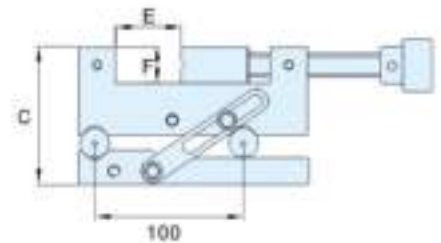
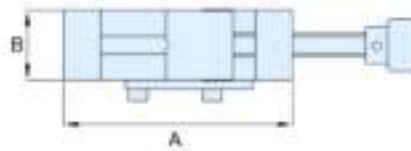
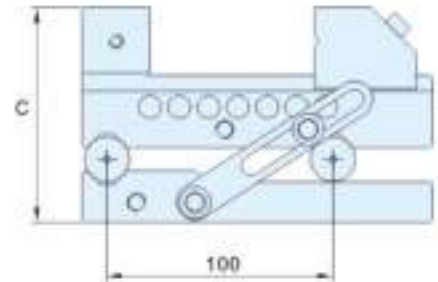
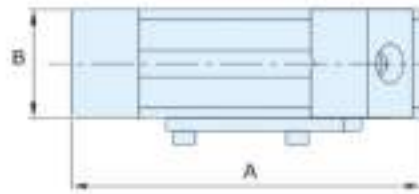

- 角度可使用至0°~45°。
- 正弦万力本身除了具备万能力的优点外，並將正弦原理利用於万力的应用范围。
- With angle between 0°~45°
- In addition to features of tool maker vise, this sine vise employs the sine theory for the angle inspection and grinding,

MODEL NO	A	B	E	F	C	ANGLE	N.W
PNH-SA20	155	48	80	30	95	0~45°	3.5KG
PNH-SA25	175	63	95	35	102		5.3KG
PNH-SA30	181	73	91	35	102		6.9KG
PNH-SA20	154	47	59	24	92		3.8KG
PNH-SA25	175	62	80	29	92		5.5KG
PNH-SA30	180	72	75	29	102		7.5KG

unit:mm

Material: SUS440  
Hardness: HRC50°~56°  
Parallelism:  $\pm 0.003\text{mm}$   
Squareness:  $\pm 0.005\text{mm}$

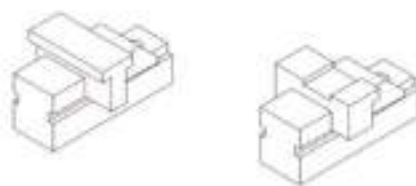
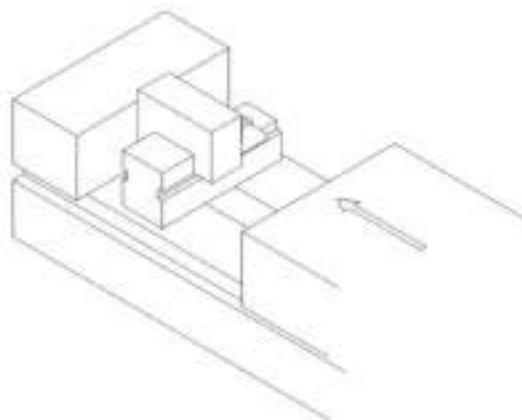
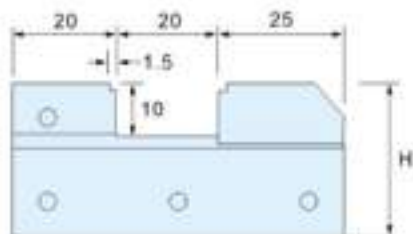
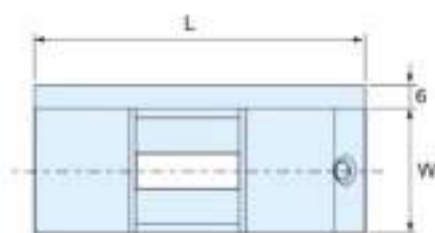

- 产品采用不锈钢，耐腐蚀。
- 适合当做电板夹具做垂直或水平方式放电加工使用。
- This tool maker vise is stainless steel made, erosion-resistant.
- Suitable for the use as electric plate fixture in vertical or horizontal electric discharge processing.

unit:mm

MODEL NO	L	W	H	侧片	N.W
PNH-S20	65	25	30	6	0.38KG



精密夹具、磨床及铣床配件目录  
Accessories for precision fixtures,  
grinding machine and milling machines

Material:SK2  
Hardness: HRC54°~58°  
Parallelism:  $\pm 0.003\text{mm}$   
Squareness:  $\pm 0.005\text{mm}$

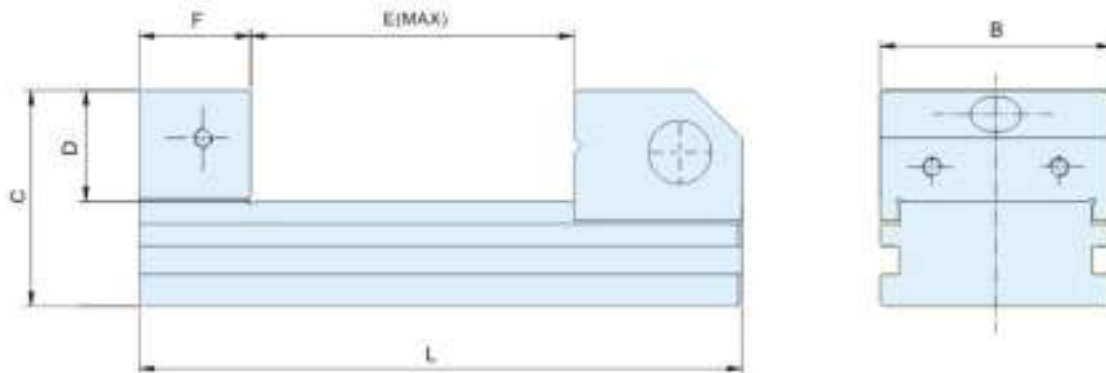

- Vh系列精密万能力在制作中，其配件吊拉运用安装弹簧设计，因此在使用只要轻便压下吊拉，就可使滑座直接前后滑动。
- In the manufacturing process of VH-series vise, spring is included in the fitting of the hauling which ease the utilization of this product as the sliding / spring saddle moves effortlessly with light pressure applied.

unit:mm

MODEL NO	L	A	B	C	D	E	N.W
PNH-VH15	105	36	48	20	20	45	0.7KG
PNH-VH20	150	48	53	25	25	75	1.59KG
PNH-VH25	176	63	59	30	30	95	2.79KG
PNH-VH30	190	73	68	35	35	100	4.21KG
PNH-VH40	245	98	90	45	45	135	9.02KG



Material:FCD/SKS93  
Parallelism: 0.01mm/ 100mm  
Squareness: 0.01mm/ 100mm

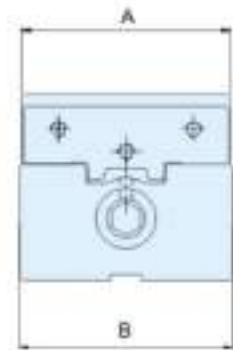
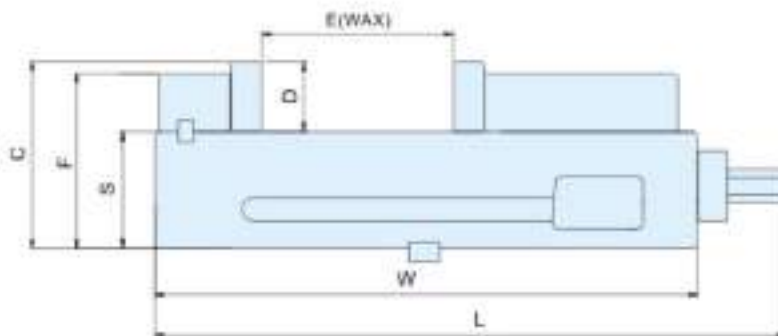

- 使用适合综合工机 (M/C)，铣床加工中数台并列使用，并确保其各工件精度一致，还可以很快夹持各并列工件，并不需要每个工件一一校正，故在多种加工程序中，依然可确保其精度。
- Properties: suitable for comprehensive processor(M/C) milling machine tied for use in several machines, and ensure that each workpiece precicion is consistent, can quickly clamping workpiece, need not all tied for each workpiece one correction, therefore, in many kinds of processing program, still can ensure its accuracy

unit:mm

MODEL NO	A	B	W	C	D	S	F	E	L	N.W
PNH-AMV4	108	110	280	90	36	60	30	100	325	13.3KG
PNH-AMV6	152	155	370	114	46	74	40	140	428	27.7KG



精密夹具、磨床及铣床配件目录  
Accessories for precision fixtures,  
grinding machine and milling machines

Material: SUJ2  
Hardness: HRC56°~60°  
Parallelism: ±0.005mm  
Squareness: ±0.005mm

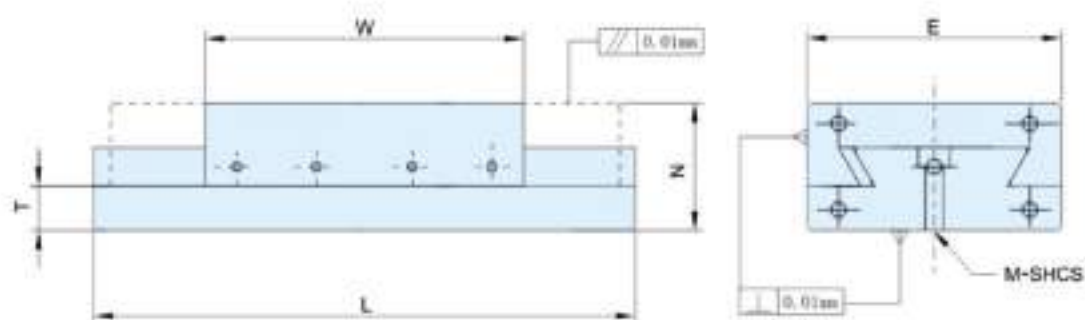
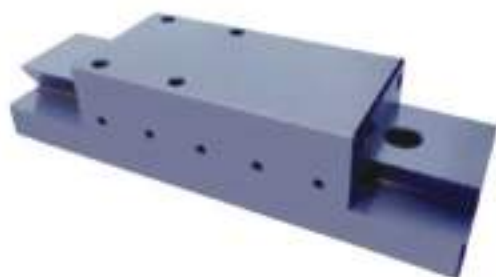

unit:mm

MODEL NO	L	E	W	N	T	SHCS	N.W
JWHD50-120	120	50	50	40	14	M5-0.8	1.6KG
JWHD50-150	150	50	50	40	14	M5-0.8	1.8KG
JWHD50-200	200	50	50	40	14	M5-0.8	2.2KG
JWHD80-150	150	80	80	44	14	M6-1.0	3.2KG
JWHD80-200	200	80	80	44	16	M6-1.0	4.0KG
JWHD80-250	250	80	80	44	16	M6-1.0	4.5KG
JWHD80-300	300	80	80	44	16	M6-1.0	5.0KG
JWHD100-180	180	100	100	49	19	M6-1.0	5.2KG
JWHD100-200	200	100	100	49	19	M6-1.0	5.5KG
JWHD100-250	250	100	100	49	19	M6-1.0	6.3KG
JWHD100-300	300	100	100	49	19	M6-1.0	7.1KG

+以上特制品，需加工定制



精密夹具,磨床及铣床配件目录  
Accessories for precision fixtures,  
grinding machine and milling machines

Material:SK2  
Hardness: HRC54°~58°  
Parallelism:  $\pm 0.003\text{mm}$   
Squareness:  $\pm 0.003\text{mm}$



PNH-MS50DX

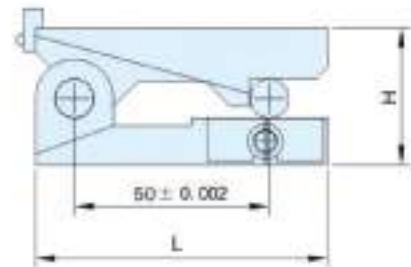

PNH-MS100DX

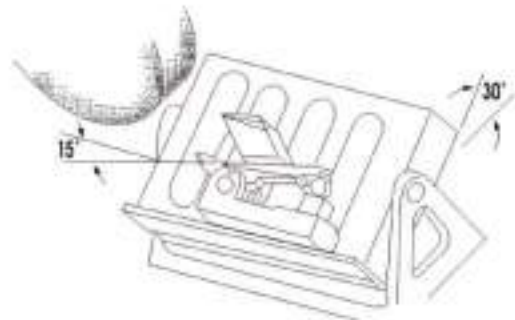
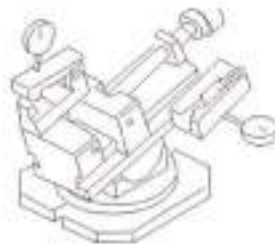
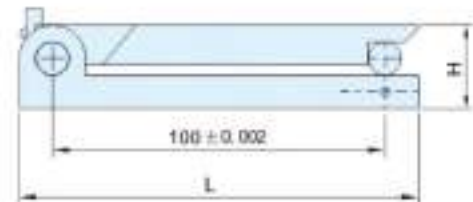

- 磁轮正弦规与万能配合使用，适合磨床上做角度成型加工，尤其适合特小型工件的角度成型加工。
- 也可以作角度的精确检查和测试，两垫轮间的中心距离精度在 $\pm 0.002\text{mm}$ 内。
- In compliance with the use of tool maker vise, this magnet sine bar is suitable for angle forming processing in grinding machine, especially for extra-small type working pieces.
- Also ideal for angle inspection and measurement. The center distance precision between wheels is within  $\pm 0.002\text{mm}$ .

unit:mm

MODEL NO	L	A	B	ANGLE	N.W
PNH-MS50DX	75	22	35	0°~45°	0.36KG
PNH-MS100DX	120	30	25	0°~45°	0.58KG